

C-16-299

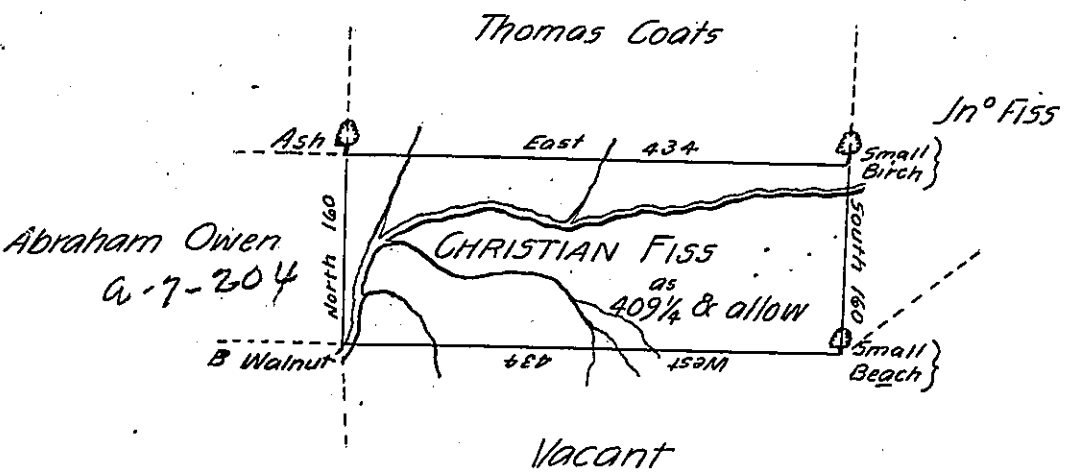

Draught of A Tract of Land Situate on the Waters of Loyalsock Creek adjoining Land of John Fiss & others in Loyalsock Township in the County of Northumberland Survey'd on the fifth day of November 1788 for Christian Fiss in Pursuance of his Warrant bearing date the first day of July 1784 Containing Four Hundred & Nine acres & one quarter & the allowance of Six p Cent for Roads &c.

This Warrant was Remov'd from the waters of Catawassa Creek, the Land being appropriated as appears by a Certificate Under the Hand of the Deputy Surveyor of that District &c

Jo: J. Wallis D.S.

*To John Lukens Esq'r
Surveyor Gen'l*

IN TESTIMONY that the above is a copy of the original remaining on file in the Department of Internal Affairs of Pennsylvania, made conformably to an Act of Assembly approved the 16th day of February, 1833, I have hereunto set my Hand and caused the Seal of said Department to be affixed at Harrisburg, this sixth day of September 1904

George D. Brown
Secretary of Internal Affairs.